

WATER SODA MAKER

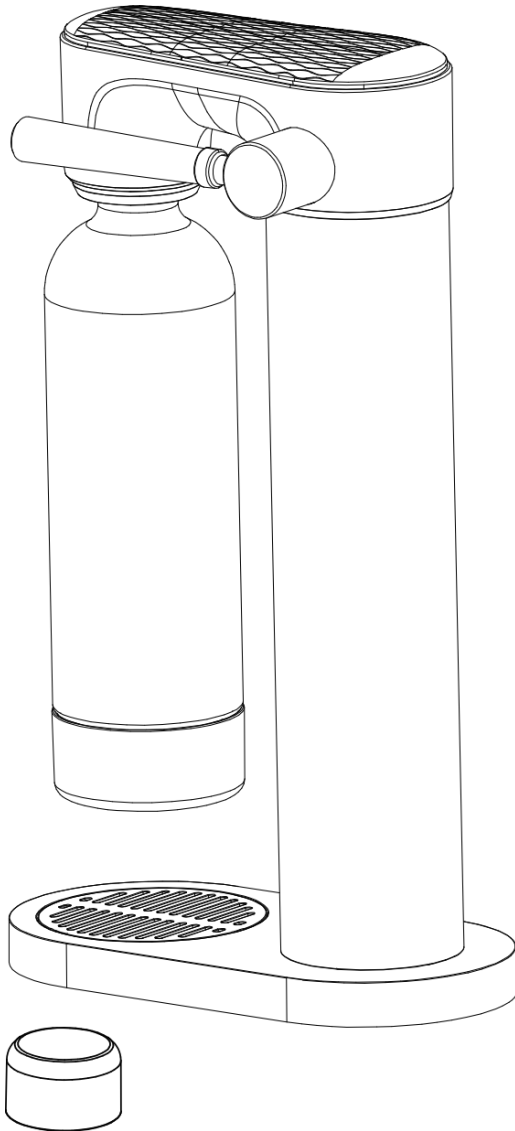

Instruction Manual

Safety Instructions

Important safety instructions that are specifically highlighted must always be observed to avoid accidents and material damage. Pay special attention to all illustrations.



Read this instruction manual carefully before using the device. Follow all safety warnings and illustrations to avoid potential injuries and damage. Keep this manual for future reference. If you give this device to someone else, be sure to include this manual as well.



Remove all packaging materials.



WARNING – Risk of suffocation!

Packaging materials are not toys. Plastic bags, sheets, and polystyrene parts can cause suffocation in children. Always keep all packaging materials out of the reach of children.



WARNING – General caution symbol!



NOTE – General tips and recommendations for using the device.



Use the device only in dry indoor areas, never outdoors.



This device must not be used by children under 12 years old. Keep the device out of reach of children. Children must not play with the device.

General Safety:

- The device may be used by persons with reduced physical, sensory, or mental capabilities, or lack of experience and knowledge, provided they are supervised or instructed on how to use the device safely and understand the risks involved.
- This device is not intended for commercial use. It is designed for household use only.
- Always place the device on a flat, horizontal surface, away from the edge of a countertop. Always use the device in an upright position.
- Use the device indoors and at room temperature. Do not use it outdoors.
- Keep the device away from heat, direct sunlight, and sharp edges. Do not place the device on or near heat sources such as gas or electric stoves, ovens, or burners, and ensure the device does not come into contact with hot surfaces or open flames.
- If the housing of the device is damaged or if the device has been dropped, do not use it until it has been checked by a qualified technician.
- Do not attempt to modify the device.
- Do not replace any part that has not been supplied or recommended by the manufacturer.
- Do not attempt to repair the device yourself.
- Do not use the device if any parts are missing or appear to be damaged.
- Never use a water bottle that is deformed, discolored, or scratched.
- Do not transport the soda maker with the carbon dioxide cylinder installed.

Safety Instructions for the Carbonating Water Bottle:

- Never place the water bottle in the freezer.
- Always keep the water bottle clean and closed with its cap to protect it from bacteria and bad odors.
- Stop using the water bottle if it shows any damage.
- Do not carbonate when the water bottle is empty or when the water level is not between the MIN and MAX lines marked on the bottle.
- Do not move the device while carbonating. Do not remove the carbon dioxide cylinder or the water bottle while the device is operating.
- Never use the device with water outside the temperature range of 5 °C to 40 °C.
- Do not carbonate for more than 5 seconds. After hearing the buzzing sound, release the button immediately.
- Do not carbonate anything other than plain water. If the water contains sugar or other substances, the valves may fail and the use of the product could be dangerous.
- Do not add anything to the plain water. Add flavoring **ONLY AFTER** carbonation.

Safety When Using the Carbon Dioxide Cylinder (sold separately):

- Do not install the carbon dioxide cylinder when its temperature is too high or too low. Leave it indoors for several hours until it gradually reaches room temperature before use. Do not use any other equipment to quickly change the cylinder's temperature.
- Do not attempt to puncture, throw, or burn the cylinder.

Keep These Instructions

Specifications:

Maximum working pressure: 0.65 MPa

Maximum ambient working temperature: 40 °C / 104 °F

Carbonation bottle capacity: 850 ml (min) / 900 ml (max)

Compatible carbon dioxide cylinder: Standard / Ø 60 mm / 425 g

Compatible Carbon Dioxide Cylinder (sold separately)

The device is compatible with standard screw-in gas cylinders of 400–425 g / 60 L from major global brands such as SodaStream, etc. (except SodaStream Quick Connect), and with other standard screw-in 400–425 g / 60 L cylinders for sparkling water machines. Other gas cylinders may appear compatible but could damage the machine or pose a safety risk.

- Except in Australia and New Zealand

Standard screw-in 400–425 g / 60 L gas cylinders are widely available on online shopping platforms.

- Depending on your location, you may also be able to purchase and refill these gas cylinders at your local supermarket.

ø60mm



Product Overview

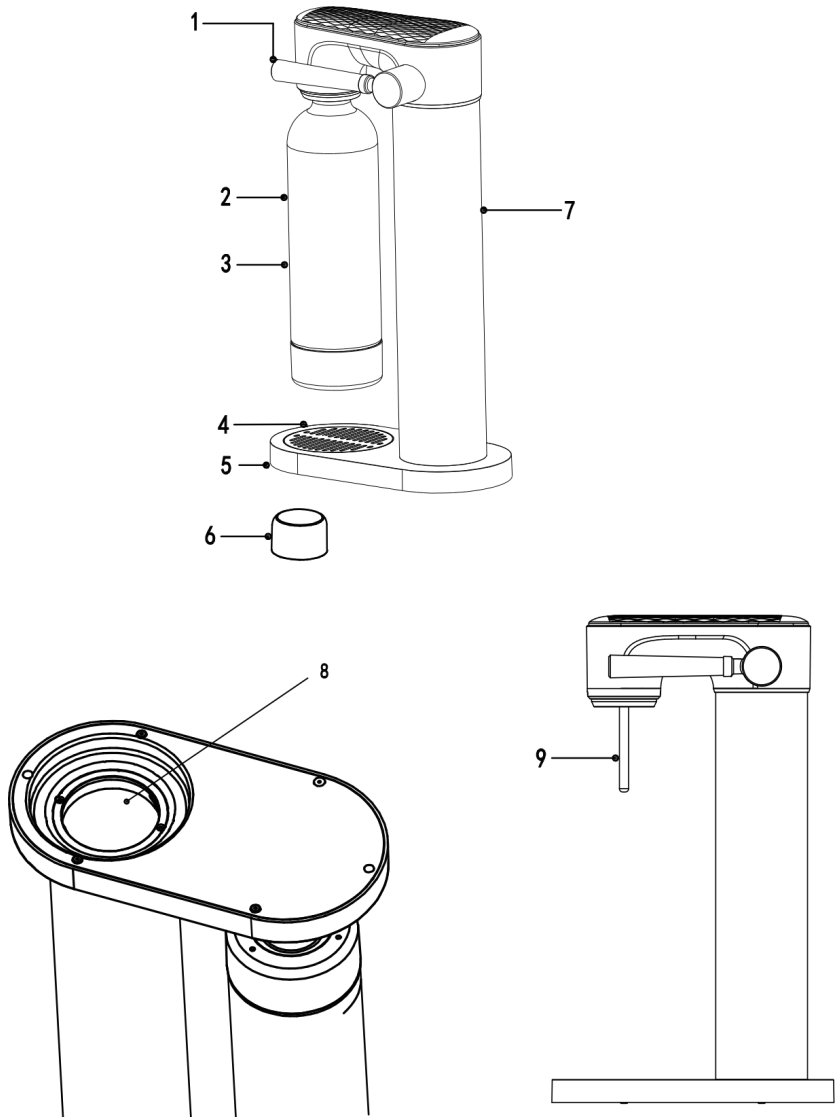

- 1. Carbonation pressure lever
- 2. Water level marks MIN / MAX
- 3. PET water bottle
- 4. Drip tray with drain
- 5. Rubber pads

- 6. Water bottle cap
- 7. Cylinder housing
- 8. CO₂ cylinder slot
- 9. Nozzle

Before First Use



Remove all packaging materials before use.

It is important to clean your product before first use or if it has not been used for an extended period.

Refer to the Cleaning and Care section for more information.

Operation

Installing and Using the Soda Maker

1. Place the soda maker on a flat surface and separately purchase a carbon dioxide cylinder.

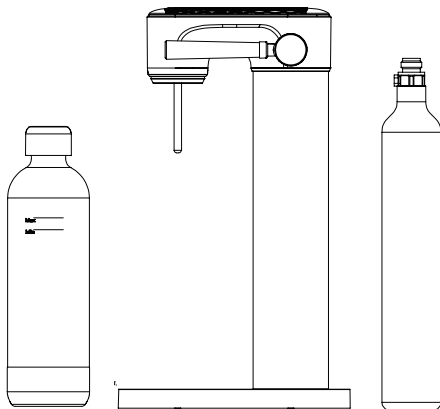

2. Turn the soda maker on its side and carefully insert the carbon dioxide cylinder into the cylinder slot (8) from the bottom of the soda maker. Screw the cylinder clockwise until it is securely fastened.

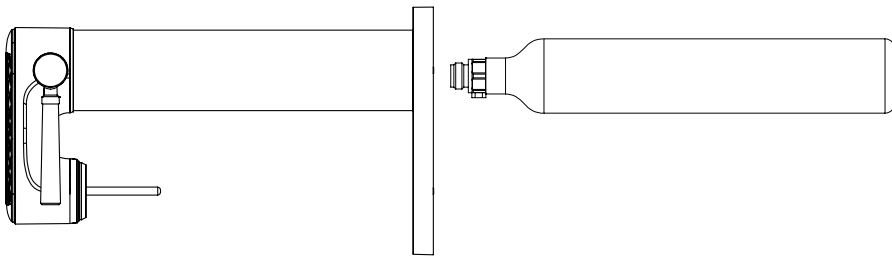

- Return the soda maker to the upright position and fill the water bottle (3) with plain water up to a level between the MIN and MAX marks (2).

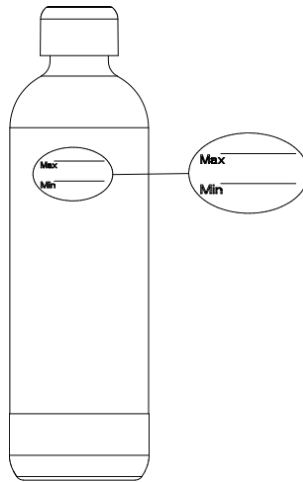

- Insert the water bottle (3) into the nozzle (9). Turn the water bottle (3) clockwise and secure it tightly.

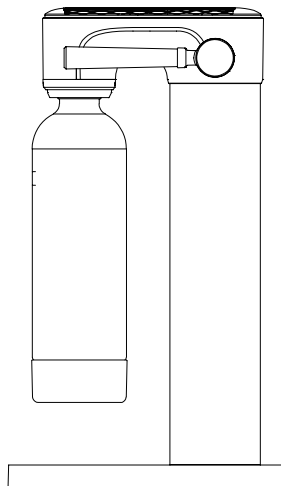

5. Press the pressure bar (1) to start carbonation. When you hear a buzzing sound, immediately release the pressure bar (1).

Press the pressure bar.

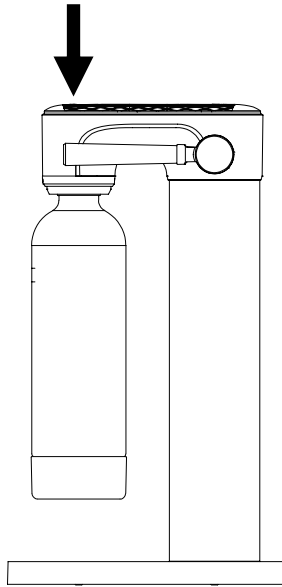

6. After carbonation, unscrew the water bottle (3) counterclockwise to detach it from the soda maker and enjoy your drink.
7. Unscrew the carbon dioxide cylinder counterclockwise and remove it from the soda maker.

Note:

- During carbonation, some ice may form in the water, which is normal.
- When a carbon dioxide cylinder is empty, check the disposal method indicated on the cylinder and dispose of it according to the instructions.
- Never carbonate continuously for more than 5 seconds at a time. This may cause gas waste or personal injury.
- You can add more gas to the water by repeating the carbonation process.
- If the product is not used for an extended period, uninstall the carbon dioxide cylinder. Store the cylinder according to its instructions.
- Replace the water bottle (3) within 24 months from the date of purchase.

Cleaning and Care

- Before and after each use, rinse the water bottle (3) thoroughly with water not exceeding 40 °C.
- Clean the nozzle (9) and the exterior of the cylinder housing (7) with a clean, soft, damp cloth.
- Empty the drip tray (4) and clean it along with the drain (4) using a clean, soft, damp cloth.
- Do not use solvents, strong detergents, or abrasive cleaners.
- Do not wash the water bottle (3) in the dishwasher.
- Do not immerse the soda maker in water.

Storage

- Thoroughly dry all parts before use or storage.
- Remove the carbon dioxide cylinder from the soda maker. Store the cylinder according to its instructions. Store the soda maker in a cool, dry place.
- Handle with care and avoid dropping or breaking during transport.

Troubleshooting

Before contacting customer service, please check the following list of problems and solutions:

The soda maker is not carbonating

- The CO₂ cylinder may be empty; replace it with a new one.
- The CO₂ cylinder may be loose; tighten it again by hand. DO NOT use tools.
- Check that the water bottle (3) is filled to a level between the MIN and MAX marks (2).
- Make sure the soda maker is in an upright position.

I hear gas escaping from the machine

- During carbonation, you may hear the sound of gas escaping — this is the normal sound of pressure being released.
- It is normal to hear a small amount of gas released at the end of the carbonation process.
- When not carbonating, hearing gas sounds is abnormal. Check and ensure the carbon dioxide cylinder is properly installed.

I can't release the water bottle from the machine

After carbonation, wait until the pressure inside the water bottle (3) returns to normal, then release the water bottle (3).

The carbonation is weak.

- If you haven't added flavor after carbonation, you can carbonate the water again for a higher level of fizz.
- Try carbonating using cold water between 5 °C and 12 °C.
- If you still experience weak carbonation, the CO₂ cylinder may be empty. Replace it with a new one.

Water overflows from inside the appliance during carbonation

- You may have pressed the pressure button (1) for too long. Release the button as soon as you hear the buzzing sound.
- Check if the water in the bottle (3) exceeds the MAX fill line (2).

Small ice crystals appear in the water during carbonation

This may occur when carbonating very cold water or in low ambient temperatures. If this happens, reduce the press duration until no ice forms; otherwise, carbonation may be affected.

Any ice that forms will melt shortly.



High pressure – Do not expose to heat

Keep the cylinders away from heat sources or direct sunlight.



For use with drinking water only

Do not use juices or sugary liquids.



Do not pierce or burn the cylinder

Explosion hazard.



Keep out of reach of children

Product not suitable for children without supervision.



Recycling and environmental safety

Recycle bottles and follow local regulations.

Imported and distributed by:

BURBUJAS CANARIAS

Calle Azimut 13, 38670 Adeje – S/C de Tenerife

info@burbujascanarias.es

Made in China